

SPECIFICATIONS & DIMENSIONS

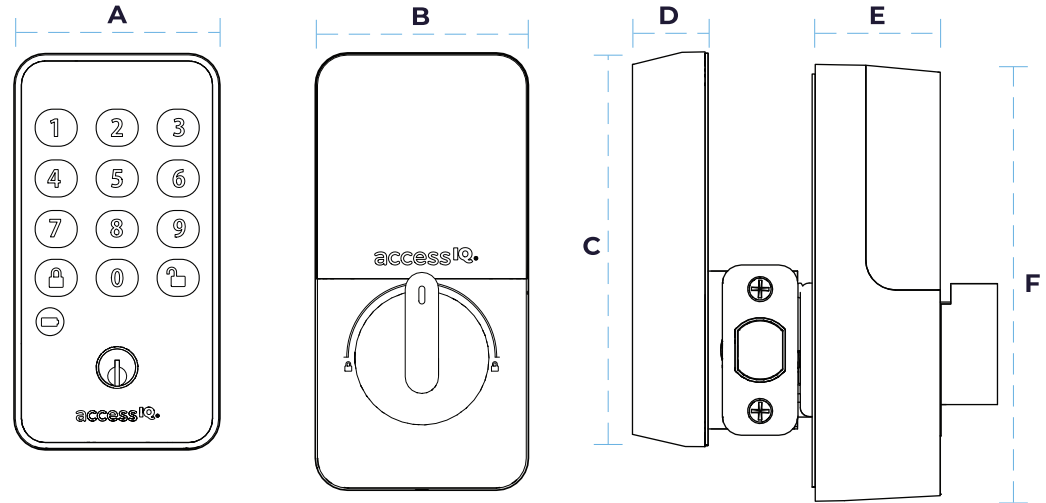

A	B	C	D	E	F
2.9 in.	2.8 in.	5.4 in.	1.0 in.	1.7 in.	5.8 in.



- Door Prep:** Face Bore: 2-1/8 in. or 1-1/2in., Edge Bore: 1 in.
- Backset:** Adjustable for 2-3/8 in. or 2-3/4 in.
- Door Thickness:** 1-3/8 in. to 1-3/4 in.
- Cylinder:** KW1
- Faceplate:** 2-1/4 in. Round corner, 2-1/4 in. Square corner
- Strikes:** 2-3/4 in. Round corner, 2-3/4 in. Square corner
- Bolt:** 1 in. Throw, steel, anti-saw pin
- User Codes:** Up to 50 user codes
- ANSI:** Meets ANSI Grade 2 standards
- UL:** Fire Rated 20 minutes
- Battery:** Rechargeable 9,600mAh Lithium-ion battery
- Operating Temp:** -31°F to 151°F (-35°C to 66°C)

Interior height designed to accommodate a privacy latch/deadbolt

Finishes Available:



KEY FEATURES

- Connects via BLE/NFC (No Wi-Fi Required)
- Unlock with Apple Wallet/Google Wallet or cards/fobs
- Keypad animations and sound toggle on/off
- Both lock and unlock buttons included
- Battery status indicator (green/yellow/red LEDs)
- Keyed cylinder for backup unlocking

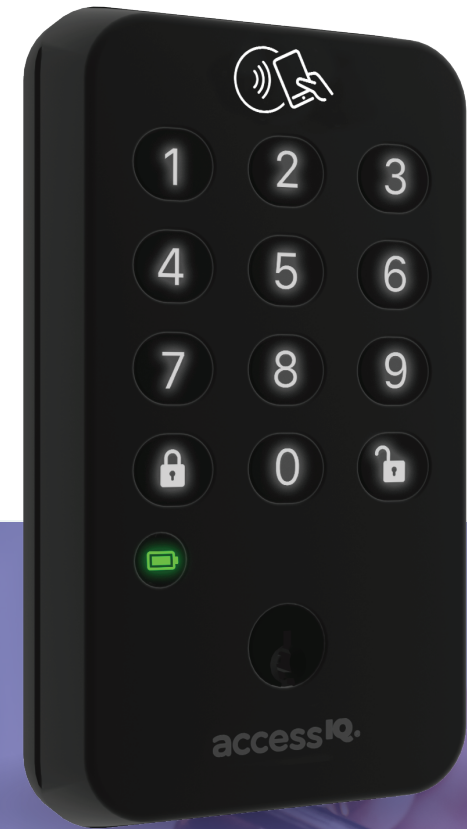

5 WAYS TO OPEN

- **Apple Wallet/Google Wallet**
- **Key card**
- **Pin code**
- **Mobile app**
- **Mechanical Key**



- Motorized for remote locking and unlocking
- Rechargeable battery no recurring replacement cost or waste*
- USB C port to boost power if battery is fully drained
- Auto-hands upon installation

*Battery life lasts over 1 year on a full charge with 10 activations/day